

NOTES:

1. INSTALLATION SHALL COMPLY WITH ALL APPLICABLE NATIONAL, STATE, AND LOCAL CODES.
2. PLEASE REFER TO PRODUCT DOCUMENTATION FOR FURTHER INFORMATION
3. UNLESS OTHERWISE SPECIFIED, ALL DIMENSIONS ARE IN INCHES [MILLIMETERS]
4. NET WEIGHT IS 7.40 LBS [3.36 KG]
- △5. LENGTH OF CORD IS 144.00 INCHES [3658 MILLIMETERS].

THIS DRAWING AND SPECIFICATIONS HEREIN ARE THE PROPERTY OF AMERICAN POWER CONVERSION AND SHALL NOT BE COPIED, REPRODUCED OR USED IN WHOLE OR IN PART, AS THE BASIS FOR THE MANUFACTURE OR SALE OF ITEMS WITHOUT WRITTEN PERMISSION FROM APC. THIS DRAWING IS BASED UPON LATEST AVAILABLE INFORMATION AND IS SUBJECT TO CHANGE WITHOUT NOTICE.



TITLE: RACK PDU, METERED, 2U
 INPUT: 120VAC, 30A, L5-30P, 12 FT CORD
 OUTPUT: (16) NEMA 5-20R
 MECHANICAL LAYOUT

PROJECT: SUBMITTAL DRAWINGS SHEET 1 OF 2

DWG NO:	AP7802	REV:	0
DRAWN:	M CRAVEN	08-DEC-08	THIRD ANGLE PROJ
ENGINEER:	Y JIANG/T HORSTMANN	09-DEC-08	
APPROVED:	B SHERIDAN	09-DEC-08	

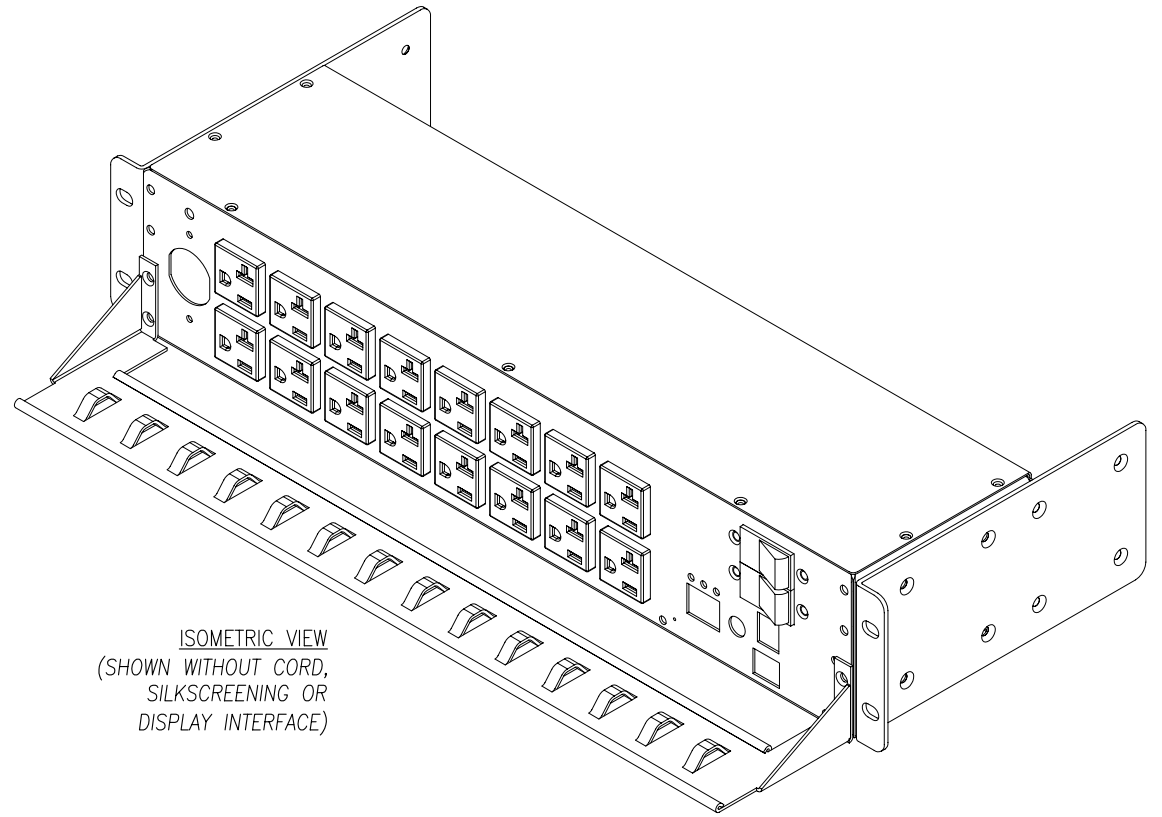
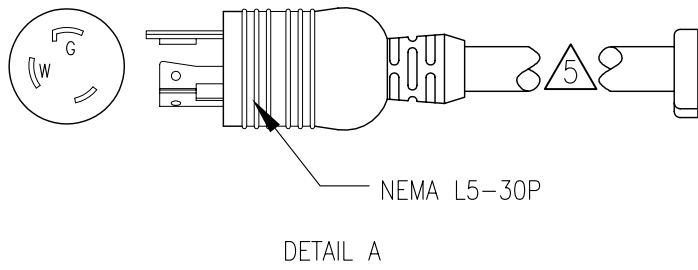

SEE SIDE VIEW
FOR OVER LENGTH
OF MOUNTING
BRACKETS

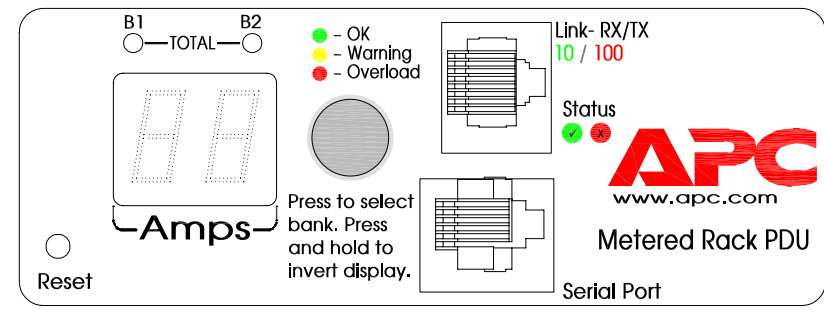
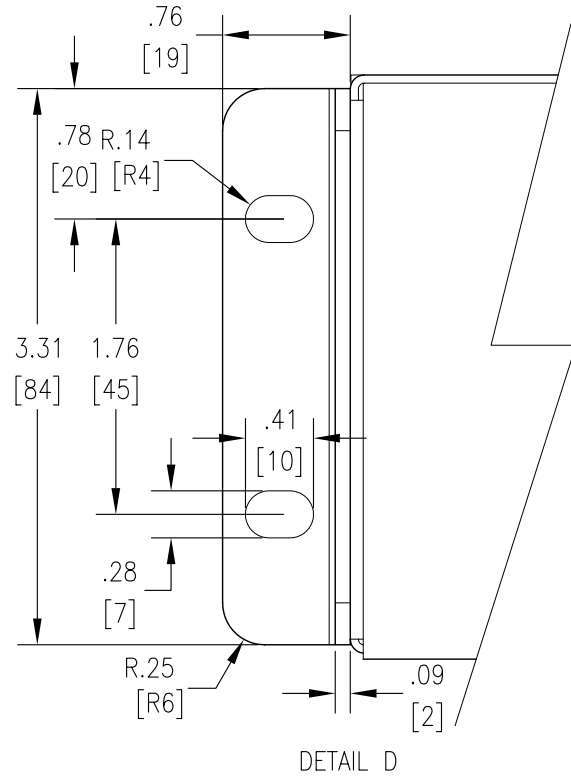

THIS DRAWING AND SPECIFICATIONS HEREIN ARE THE PROPERTY OF AMERICAN POWER CONVERSION AND SHALL NOT BE COPIED, REPRODUCED OR USED IN WHOLE OR IN PART, AS THE BASIS FOR THE MANUFACTURE OR SALE OF ITEMS WITHOUT WRITTEN PERMISSION FROM APC. THIS DRAWING IS BASED UPON LATEST AVAILABLE INFORMATION AND IS SUBJECT TO CHANGE WITHOUT NOTICE.



TITLE: RACK PDU, METERED, 2U
INPUT: 120VAC, 30A, L5-30P, 12 FT CORD
OUTPUT: (16) NEMA 5-20R
ISOMETRIC AND DETAIL VIEWS

DWG NO: AP7802
DRAWN: M CRAVEN 08-DEC-08
ENGINEER: Y JIANG/T HORSTMANN 09-DEC-08
APPROVED: B SHERIDAN 09-DEC-08

REV: 0
THIRD ANGLE PROJ

PROJECT: SUBMITTAL DRAWINGS SHEET 2 OF 2